



# Importing UDS on VMware vSphere



#SmartDigitalWorkplace  
— VIRTUAL CABLE —

## Index

INTRODUCTION .....	2
Download UDS Appliances .....	2
Import UDS Appliances on the virtual platform.....	3
Start UDS servers.....	7
THE SMART DIGITAL WORKPLACE SOLUTION BY VIRTUAL CABLE .....	8
About UDS Enterprise.....	8
About Virtual Cable.....	8

## INTRODUCTION

UDS Enterprise components are provided as Virtual Appliances. To upload these items to the VMware vSphere platform, perform the following tasks:

## Download UDS Appliances

Access your account at:

<https://myuds.udsenterprise.com/portal/MyUDSEnterprise/crm/login.sas>

Once inside, in the "My Downloads" section, select "UDS Enterprise Appliances compatible with VMware vSphere & Cloud Director" (.OVA format):

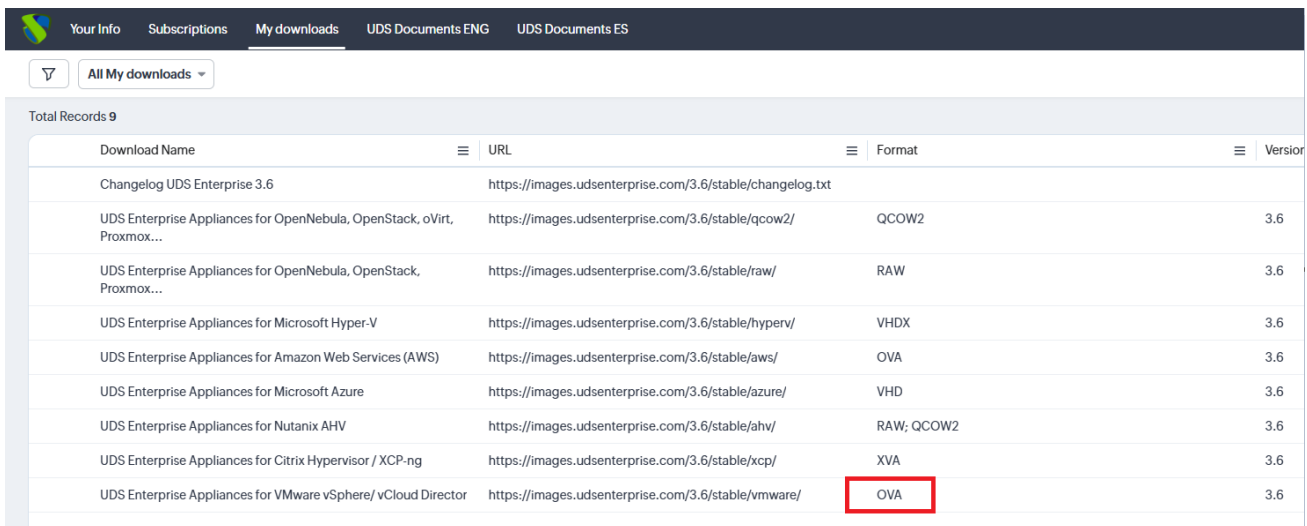

Download Name	URL	Format	Version
Changelog UDS Enterprise 3.6	<a href="https://images.udsenterprise.com/3.6/stable/changelog.txt">https://images.udsenterprise.com/3.6/stable/changelog.txt</a>		
UDS Enterprise Appliances for OpenNebula, OpenStack, oVirt, Proxmox...	<a href="https://images.udsenterprise.com/3.6/stable/qcow2/">https://images.udsenterprise.com/3.6/stable/qcow2/</a>	QCOW2	3.6
UDS Enterprise Appliances for OpenNebula, OpenStack, Proxmox...	<a href="https://images.udsenterprise.com/3.6/stable/raw/">https://images.udsenterprise.com/3.6/stable/raw/</a>	RAW	3.6
UDS Enterprise Appliances for Microsoft Hyper-V	<a href="https://images.udsenterprise.com/3.6/stable/hyperv/">https://images.udsenterprise.com/3.6/stable/hyperv/</a>	VHDX	3.6
UDS Enterprise Appliances for Amazon Web Services (AWS)	<a href="https://images.udsenterprise.com/3.6/stable/aws/">https://images.udsenterprise.com/3.6/stable/aws/</a>	OVA	3.6
UDS Enterprise Appliances for Microsoft Azure	<a href="https://images.udsenterprise.com/3.6/stable/azure/">https://images.udsenterprise.com/3.6/stable/azure/</a>	VHD	3.6
UDS Enterprise Appliances for Nutanix AHV	<a href="https://images.udsenterprise.com/3.6/stable/ahv/">https://images.udsenterprise.com/3.6/stable/ahv/</a>	RAW, QCOW2	3.6
UDS Enterprise Appliances for Citrix Hypervisor / XCP-ng	<a href="https://images.udsenterprise.com/3.6/stable/xcp/">https://images.udsenterprise.com/3.6/stable/xcp/</a>	XVA	3.6
UDS Enterprise Appliances for VMware vSphere/ vCloud Director	<a href="https://images.udsenterprise.com/3.6/stable/vmware/">https://images.udsenterprise.com/3.6/stable/vmware/</a>	OVA	3.6

It will take you to a download repository where you'll find the UDS Appliances:

## UDS Enterprise 4.0 RC Images

Please, select the option that best fit your needs

- [VMWare Images](#)
- [XCP-ng/XenServer Images](#)
- [Nutanix AHV Images](#)
- [Azure Images](#)
- [AWS Images](#)
- [Cloud Images](#)
- [Hyper-V](#)
- [RAW Images \(For OpenStack, OpenNebula, ProxMox, ...\)](#)
- [QCOW2 Images \(For OpenStack, OpenNebula, ProxMox, oVirt >= 4.2, ...\)](#)

## Import UDS Appliances on the virtual platform

Download the UDS Appliances. See below an example with the UDS Server Appliance (**UDS-Server-XXova**).

Access the VMware vSphere environment and select the option "**Deploy OVF Template**":

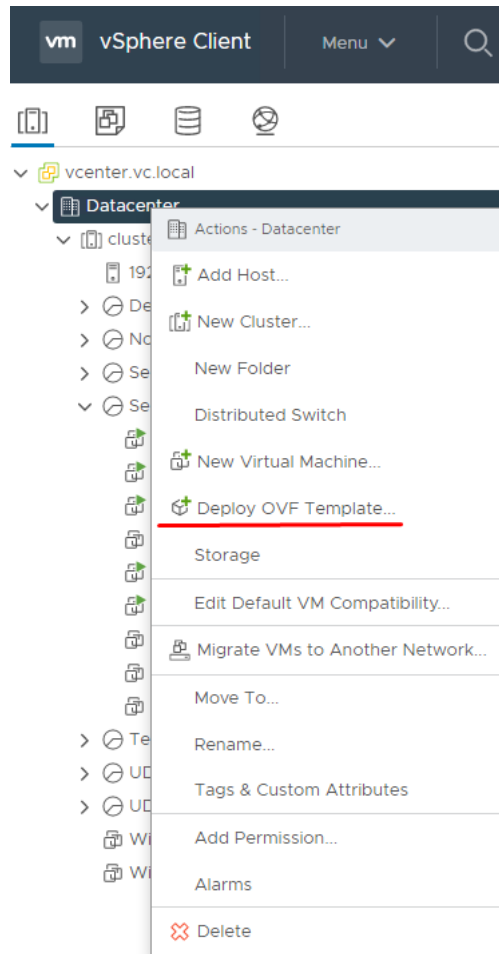

Search and select the previously downloaded UDS Appliance.

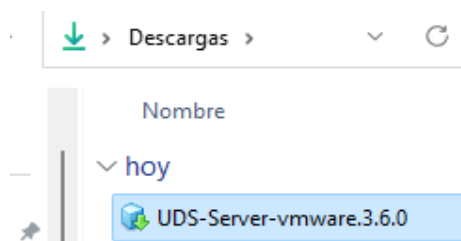

Choose it and click on next:

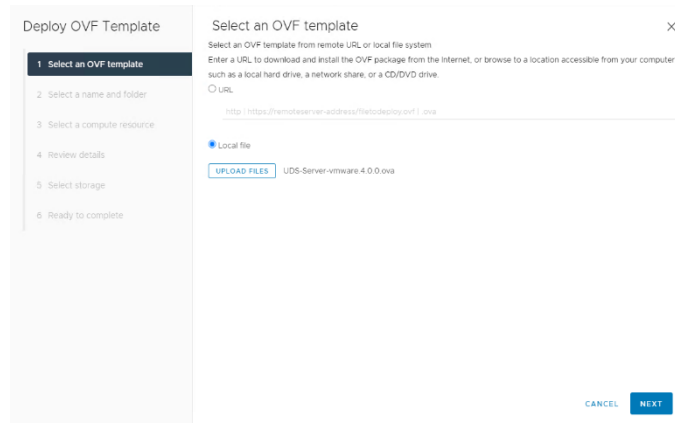

Indicate the name of the virtual machine and its folder.

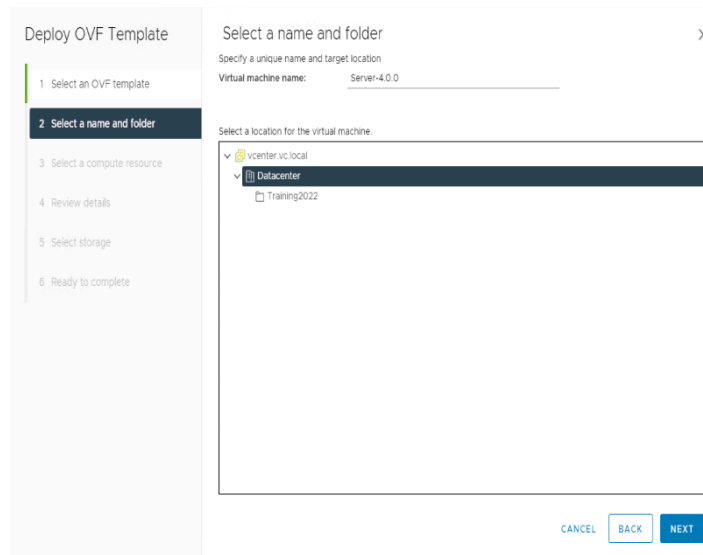

Select where the machine will be hosted:

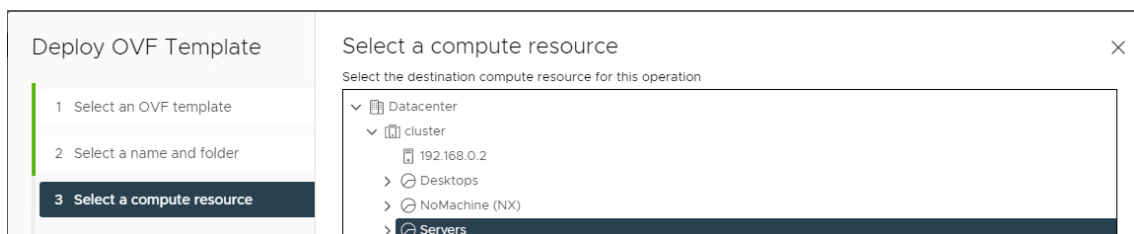

Below you can see details of the machine.

### Deploy OVF Template

- 1 Select an OVF template
- 2 Select a name and folder
- 3 Select a compute resource
- 4 Review details

### Review details

Verify the template details.

Publisher	No certificate present
Download size	905.3 MB
Size on disk	Unknown (thin provisioned) 8.0 GB (thick provisioned)

The next step will be to select the storage.

### Deploy OVF Template

- 1 Select an OVF template
- 2 Select a name and folder
- 3 Select a compute resource
- 4 Review details
- 5 Select storage
- 6 Select networks
- 7 Ready to complete

### Select storage

Select the storage for the configuration and disk files

Encrypt this virtual machine (Requires Key Management Server)

Select virtual disk format: ▼

VM Storage Policy: Datastore Default ▼

Disable Storage DRS for this virtual machine

	Name	Storage Cor	Capacity	Provisioner	Free	Type	Cluster
<input type="radio"/>	SATA-1	--	1.82 TB	2.25 TB	939.47 GB	VMFS 6	
<input type="radio"/>	SATA-	--	1.81 TB	608.18 GB	1.59 TB	VMFS 6	
<input type="radio"/>	SSD-1	--	419 GB	824.64 GB	126.46 GB	VMFS 6	
<input type="radio"/>	SSD-2	--	419 GB	852.47 GB	192.39 GB	VMFS 6	

4 items

Next choose the type of network that the machine will have.

### Deploy OVF Template

- 1 Select an OVF template
- 2 Select a name and folder
- 3 Select a compute resource
- 4 Review details
- 5 Select storage
- 6 Select networks
- 7 Ready to complete

### Select networks

Select a destination network for each source network.

Source Network	Destination Network
bridged	LAN ▼

1 item

#### IP Allocation Settings

IP allocation: Static - Manual

IP protocol: IPv4

To finish, you can see a summary of all the details configured in the machine.

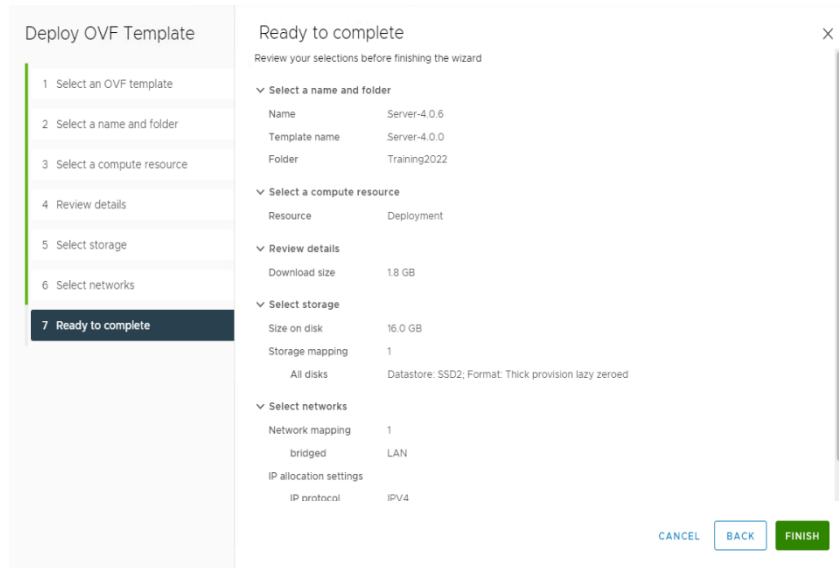

The screenshot shows the 'Ready to complete' step of the 'Deploy OVF Template' wizard. On the left, a navigation pane lists seven steps: 1. Select an OVF template, 2. Select a name and folder, 3. Select a compute resource, 4. Review details, 5. Select storage, 6. Select networks, and 7. Ready to complete (highlighted). The main area displays a summary of the configuration:

- Ready to complete**  
Review your selections before finishing the wizard
- Select a name and folder**
  - Name: Server-4.0.6
  - Template name: Server-4.0.0
  - Folder: Training2022
- Select a compute resource**
  - Resource: Deployment
- Review details**
  - Download size: 18 GB
- Select storage**
  - Size on disk: 16.0 GB
  - Storage mapping: 1
  - All disks: Datastore: SSD2; Format: Thick provision lazy zeroed
- Select networks**
  - Network mapping: 1
    - bridged: LAN
  - IP allocation settings
    - IP protocol: IPv4

At the bottom right, there are three buttons: CANCEL, BACK, and FINISH.

## Start UDS servers

Once the import of the UDS Appliance is finished, turn on the VM and start a console to begin with the server configuration.

```

UDS Enterprise Server v4.0.0 broker-400 tty1
broker-400 login: root (automatic login)
Linux broker-400 6.1.0-31-amd64 #1 SMP PREEMPT_DYNAMIC Debian 6.1.128-1 (2025-02-07) x86_64
UDS Enterprise Server v4.0.0

      ((((((/,,,,,,))))))
      (((((((((/,,,,,,)))))))))
      /((((((((((/,,,,,,)))))))))
      /((((((((((/,,,,,,)))))))))
      ,*((((((((((((/,,,,,,)))))))))
      ,/((((((((((/,,,,,,)))))))))
      ##*#/,((((((((((/,,,,,,)))))))))
      ,/((((((((((/,,,,,,)))))))))
      ,/#####(*/((((((((((/,,,,,,)))))))))
      ,/#####/,*/((((((((((/,,,,,,)))))))))
      *#####(,*/((((((((((/,,,,,,)))))))))
      *#####/,*/((((((((((/,,,,,,)))))))))
      ,/#####!,*/((((((((((/,,,,,,)))))))))
      ,*##*,*(((
      ,*

UDS Enterprise comes with ABSOLUTELY NO WARRANTY,
to the extent permitted by applicable law.
Last login: Fri Feb 14 18:16:03 CET 2025 on tty1
UDS Enterprise broker CLI tool
Your appliance is currently unconfigured.
In order to configure it, you need to go through the setup process.
Since UDS 3.0, the configuration is done using a web browser.
UDS Enterprise setup launcher
Your appliance IP is 192.168.14.85. We are going to start the web setup process for you right n
To configure your appliance, please go to this URL: https://192.168.14.85:9900
Note that, by default, UDS Appliance generates self signed certificates.
If you want to use your own certificates, please copy them to /etc/certs/ folder.
The setup process will be available until finished or the appliance is rebooted.
Your setup code is: Yj9jp4XA

YJ9JP4XA
  
```

Wait for the VM to start and proceed with the configuration of the UDS Appliance (see [UDS Enterprise Installation, Administration and User Manual](#)).

### NOTES:

1. If you want to use the UDS Tunnel component (which will provide you with WAN access and HTML5 access to the different services) repeat the same tasks previously described using the UDS-Tuneler.xxova file.
1. If you do not have your own database server to host the UDS Enterprise database, from the same repository you can download a virtual machine with a database server already prepared for this purpose. We remind you that this server is not part of UDS Enterprise, and therefore, it is not supported.



## THE SMART DIGITAL WORKPLACE SOLUTION BY VIRTUAL CABLE

### About UDS Enterprise

[UDS Enterprise](#) is a new software concept for creating a **fully customized workplace virtualization** platform. It provides **secure 24x7 access** from **any location and device** to all applications and software of an organization or educational center.

It allows you to combine Windows and Linux **desktop and application virtualization** in a single console, as well **as remote access** to Windows, Linux and macOS computers. Its Open Source base guarantees **compatibility with any third-party technology**. It can be deployed on-premises, in a public, private, hybrid or **multicloud**. You can even combine several environments at the same time and perform automatic and **intelligent overflows** to optimize performance and efficiency. All with a **single subscription**.

### About Virtual Cable

[Virtual Cable](#) is a company specialized in the digital **transformation of the workplace**. The company develops, supports and markets UDS Enterprise. It has recently been recognized as an **IDC Innovator in Virtual Client Computing** worldwide. Its team of experts has designed **smart digital workplace solutions (VDI, vApp and remote access to physical computers)** tailored to each sector to provide a unique user experience fully adapted to the needs of each user profile. Virtual Cable professionals have **more than 30 years** of experience in IT and software development and more than 15 years in virtualization technologies. **Everyday millions of Windows and Linux virtual desktops** are deployed with UDS Enterprise around the world.